

REVISION RECORD				
REV	ECO	DESCRIPTION	DRFT	CHKD

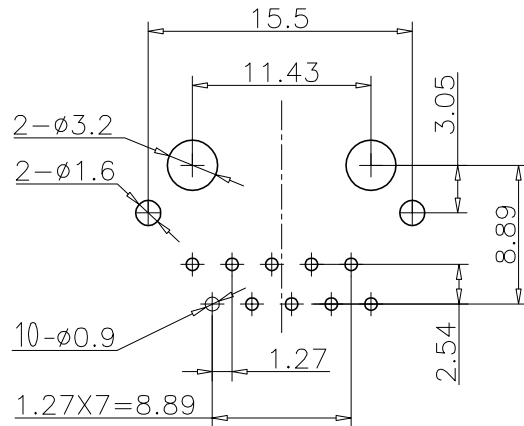
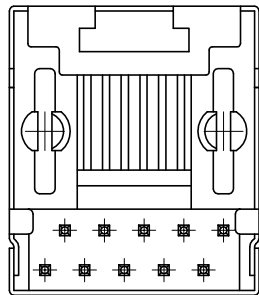
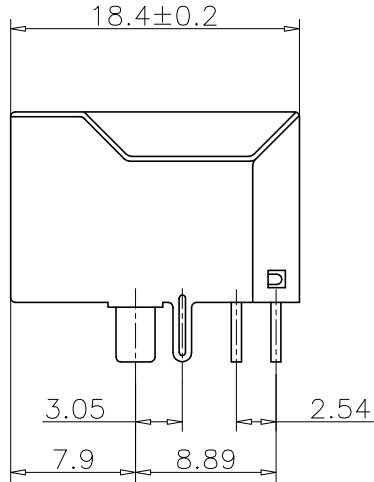
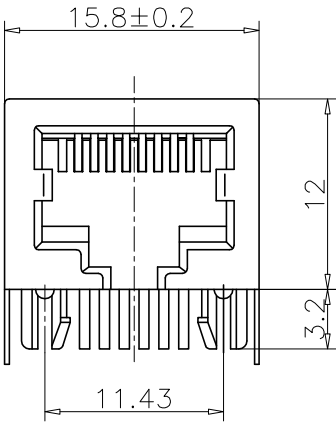

PC Board Layout
Component Side Shown

NOTES:

MATERIAL :

- 1.HOUSING MATERIAL :GLASS FILLED POLYESTER UL94V-0.
- 2.CONTACT MATERIAL :PHOSPHOR BRONZE ϕ 0.45mm.
- 3.PLATING :GOLD PLATING OVER NICKEL.
- 4.SHIELD :0.20mm THICKNESS COPPER ALLOY WITH NICKEL PLATED.

ELECTRICAL:

- 1.VOLTAGE RATING :125 VAC RMS.
- 2.CURRENT RATING :1.5 AMP.
- 3.CONTACT RESISTANCE :30 MILLIOHMS MAX.
- 4.INSULATION RESISTANCE :500 MEGOHMS MIN @ 500V DC .
- 5.DIELECTRIC WITHSTANDING RESISTANCE :1000V AC RMS 50Hz. 1MIN.

MECHANICAL:

- 1.DURRABILITY :750 CYCLES MIN.
- 2.PCB RETENTION PRE-SOLDER :1 LB MIN.

ENVIRONMENTAL:

- 1. STORAGE : -40°C~+85°C
- 2. OPERATION : 0°C~+70°C

DETACHED LISTS 		DFTO: SHB	DATE: 2007.05.03	<h2 style="margin: 0;">Coorle Technology</h2>		
	TOLERANCES EXCEPT AS NOTED	CHKD: LANBO	DATE: 2007.05.03			
	MH	* ∅ ± 0.15	MFP:	DATE:	TITLE 56 SIDE ENTRY JACK 10P10C	
	.00 ± 0.075	*	APPVL:	DATE:		
.00 ± 0.05	*	MATERIAL :		DRAWING NO. TES481002 /PART NO.		
ANGLES ± 0.5		QTY :				SIZE A3
THIRD ANGLE PROJECTION		FINISH :		DO NOT SCALE DRAWING		
		SCALE :				SHEET X

H
G
F
E
D
C
B
A